

Ship/Shore Link System

X'LESS Excellent Linked Emergency Shutdown System

Linked 'SHIP-TO-SHORE & SHIP-TO-SHIP' Emergency Shutdown System

Safety issues (i.e. High tank levels, high or low tank pressures, excessive pressure in the cargo transfer system, fire or gas detection and excessive ship movement or break-out) exist when the tanker (COT, P/C and C/T, etc) is connected to terminal to load or unload cargo.

In this case, each system is shut down separately by communicating each other on terminal and ship but it still remains environmental problems caused by oil-spill and safety issues due to communication and operation delay.

For that reason, OCIMF recommends followings to all kinds of tankers to be built in since January 1st, 2019. Ships and terminals should be provided with the necessary equipment to enable inter-connection of Emergency ShutDown system ("ESD" hereinafter) and on activation of own ESD, the other party's ESD should be automatically activated.

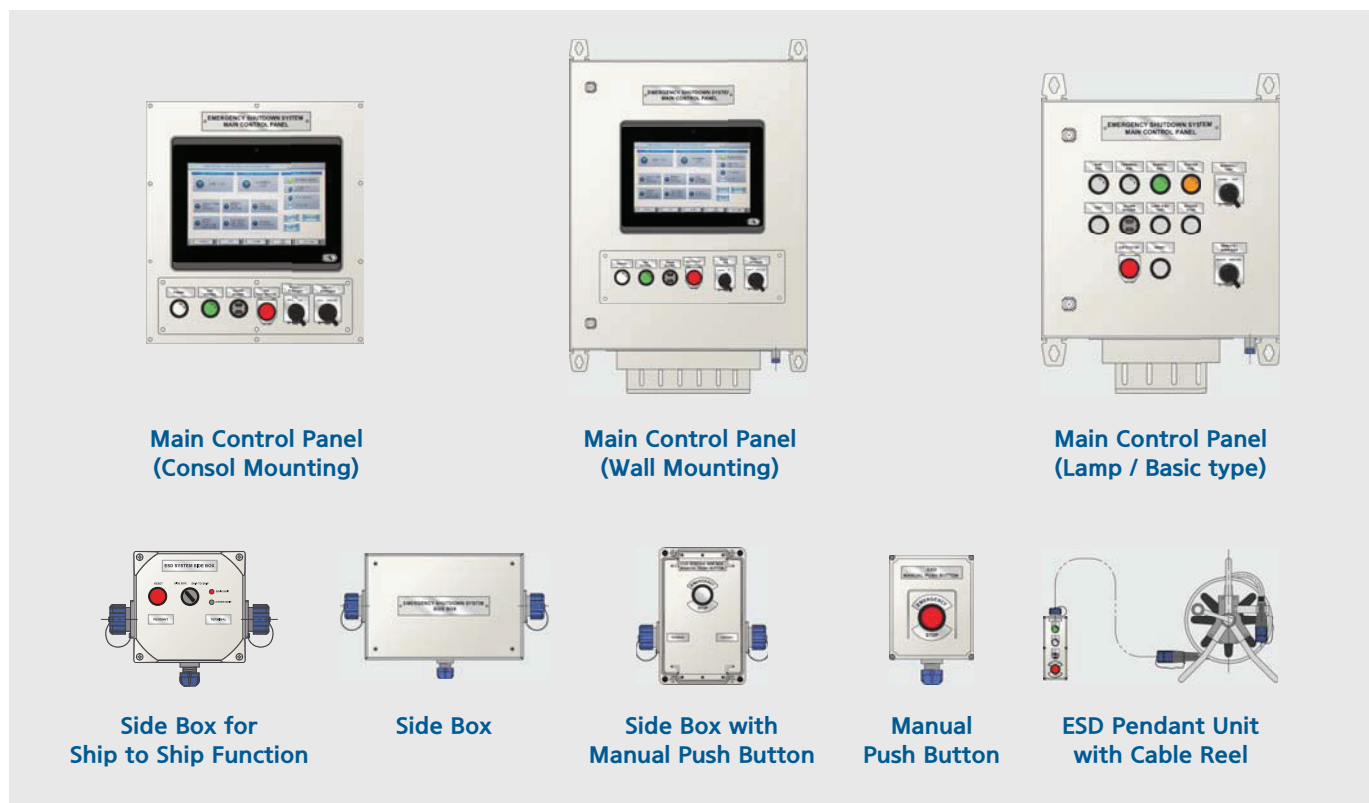

Our new development "Linked Emergency Shutdown System" is to apply to oil and chemical tanker and it fully meets OCIMF 2017 recommendation. It was completely developed through much consultation and discussion with an expert group of major shipyards and ship owners. Therefore, we are confident that our developed system is satisfied with requirements of various customers and also it is competitive system due to many advantages in terms of operation, installation and space, etc.

And we call the system with our brand name, X' LESS, i.e. EXCELLENT LINKED EMERGENCY SHUTDOWN SYSTEM.

Ship/Shore Link System

X'LESS Excellent Linked Emergency Shutdown System

Schematic Diagram

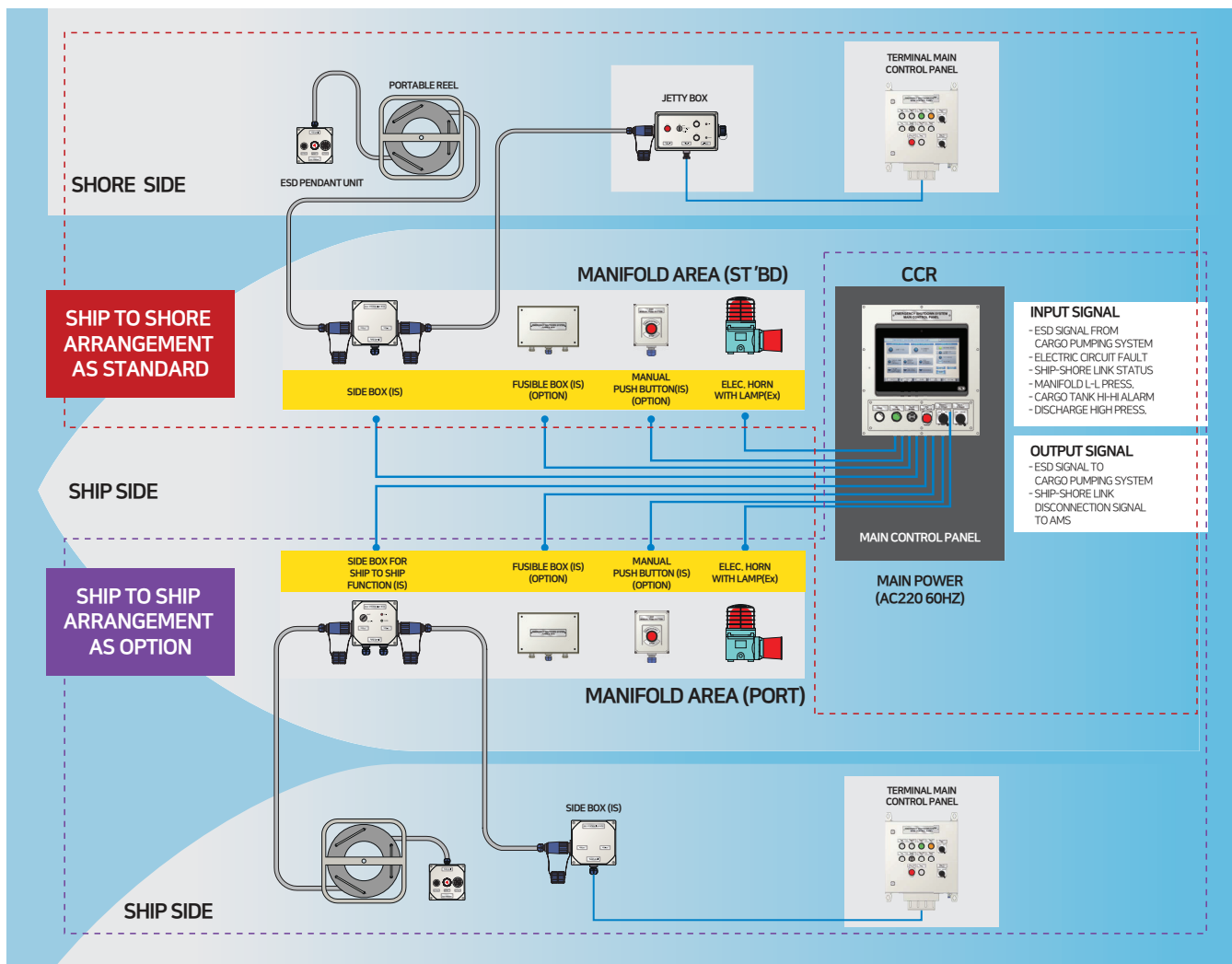

Key Features & Benefits

- Linked ESD system for Ship Applications
- Used in Liquid Chemical and Oil Tanker
- Intrinsically Safe
- Suitable for EX ia IIB Hazardous area Applications
- System Test Function
- 30m, 50m Pendant Cable in Reel
- Simple & Competitive Design
- Customized System